

SPECIFICATIONS

General Information

- Pre-assembled panels along with lift off hinges allow for a simple and quick installation
- Perimeter compression gaskets efficiently seal and minimize air leakage
- Right or Left Hinged option (defined by which direction the door swings as you look at the aisle from the outside)
- Multiwall option adheres to 2013 NFPA 75 flame spread and smoke development requirements
- No-threshold design prevents obstructions or tripping
- Sturdy aluminum framing
- Fully supported by floor with rack attachments for lateral stability

Weights

- 140 lbs. – Clear polycarbonate
- 110 lbs. – Multiwall polycarbonate

Dimensions

- 66.5" width x 86" height x 3.15" depth (custom sizes available)
- 36" max opening width

OPTIONS

Panel Options

- Clear polycarbonate
 - Fully transparent
 - ASTM D-635 listed
 - 6mm thick with edge-sealing gaskets
- Multiwall polycarbonate
 - Semi-transparent
 - Flame spread index <50
 - Smoke development <450
 - ASTM E-84 and ASTM D-635 listed
 - UL 94 Listed
 - 6mm thick with edge-sealing gaskets

Aluminum Extrusion Finish Options

- Clear Anodized
- Black Anodized

INCLUDED COMPONENTS

- ContainAire® Single Hinged Door
- Floor and rack mounting hardware
- Installation guide



Lift Off Hinge allows for easy installation and maintenance

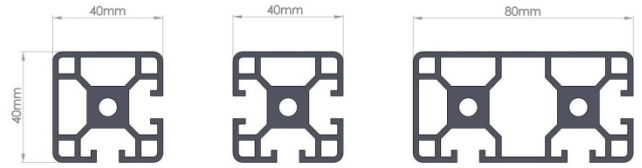

Custom Extrusion Profiles

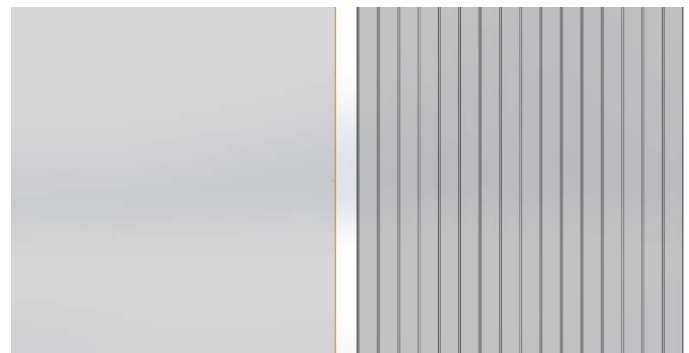

Polycarbonate
Clear/Transparent

Polycarbonate
Semi-Transparent/Multiwall



Hinged Door used at end of hot aisle in conjunction with a ContainAire HAC system

PART NUMBERS

